

## Universal Medical Rail Systems

Product Code: **Various**

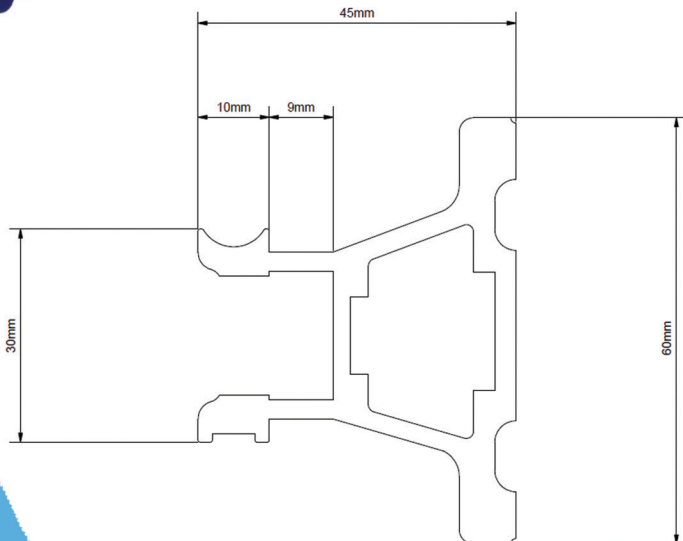

### Specifications:

Extruded Aluminium  
Anodised Silver Finish  
MRI Conditional  
Fixes Directly to wall  
Complete with End Caps & Infill Strip  
Mounting holes are to be drilled on installation

### Product Codes:

R0500 - 500mm Rail Length  
R0750 - 750mm Rail Length  
R1000 - 1000mm Rail Length  
R1000-5 - 1500mm Rail Length  
R2000 - 2000mm Rail Length  
R2500 - 2500mm Rail Length  
R3000 - 3000mm Rail Length  
R6000 - 6000mm Rail Length

### Accessories:

R1000A - End Cap Only (each)  
R1000B - Rail Infill Strip Only (per meter)  
R1302 - Rail Clamp 44mm Only

Oxylitre Holdings Limited Rail Systems and Rail Fittings cover a comprehensive range of requirements. Our extruded heavy duty aluminium rail is suitable for use in various medical environments, and comes supplied with plastic end caps and infill. Anodised silver, our rail is available in numerous standard lengths, non-standard lengths are available on request. Our extensive range of Rail Fittings have been designed to create flexible solutions for the safe storage of Medical Sundries. A full and comprehensive look at our range can be found in our product index.

Oxylitre's range of Medical Rail are dependable, with a minimum maintain required. Our Range of Medical Rail come with a long service life and a **7 year warranty**.